

PLENUM BOX 3x75mm/2x90mm

Plenum box is delivered in a factory assembled state. Plenum boxes are equipped with rotatable mounting wings allowing to install boxes both on a ceiling inside an insulation layer under the screed or inside a suspended ceiling.

- 1 Choose the place to install the plenum box. The box has to be situated minimum 350 mm from walls. The diameter of the hole has to be minimum 135 mm.

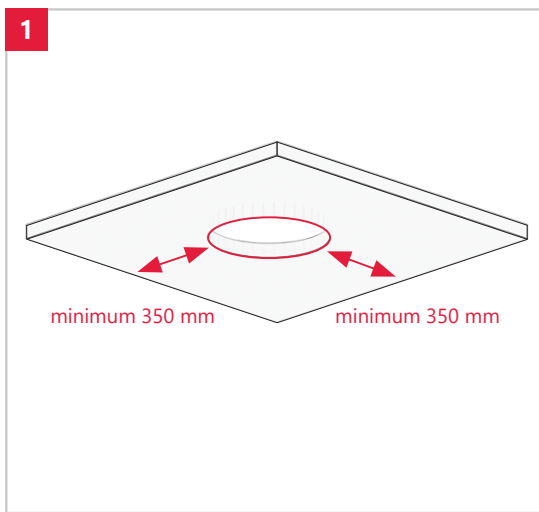

- 2 i 3 Remove the regulation bolts and take out the mounting wings. Set them in the desired position, depending on the type of installation and the adjust the height by using regulation bolt. In case of installation on the ceiling, first make a hole through the ceiling.

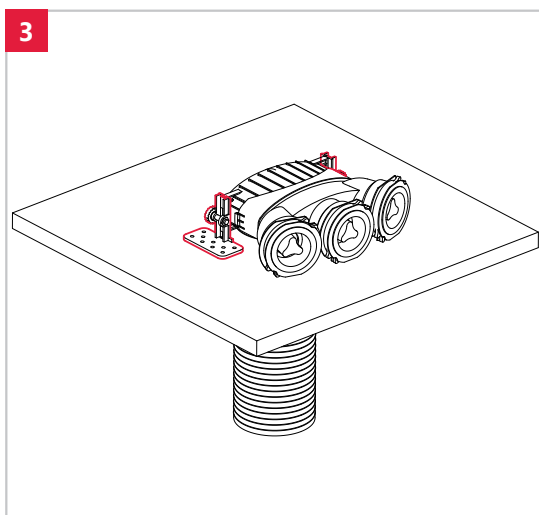
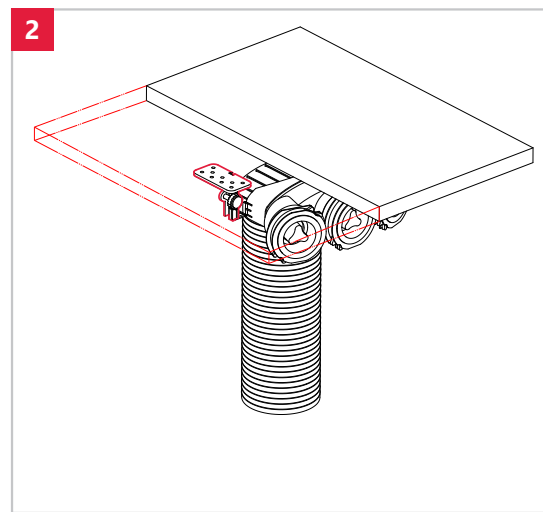

- 4 Fix the plenum box securely to the ceiling using the holes in the mounting wings by, for example, screws. Diameter of the wing holes is 5,3 mm.

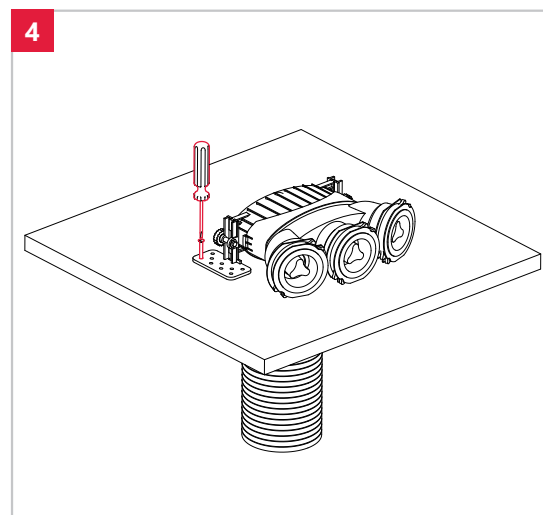

- 5 Take out the end cap from the socket, put the seal on the first furrow of the pipe and slide the pipe into the socket. Make sure that the fastening ring is in the locked position. When installing two pipes, use two outer sockets, one pipe - the middle socket. Unused sockets have to remain capped.

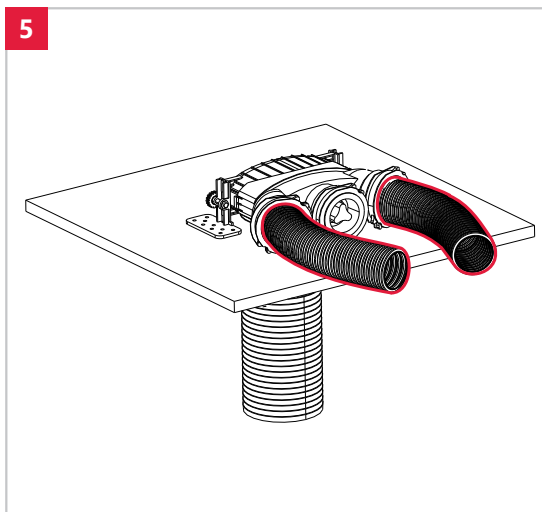

- 6 Cut the disc valve socket pipe of plenum box perpendicularly and on the same level as the ceiling surface. Place the endcap in the pipe for duration of construction works.

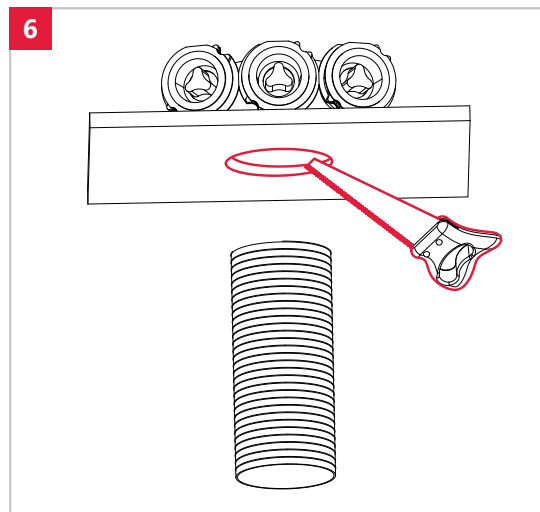

- 7 After construction works are finished place the disc valve inside the prepared pipe.

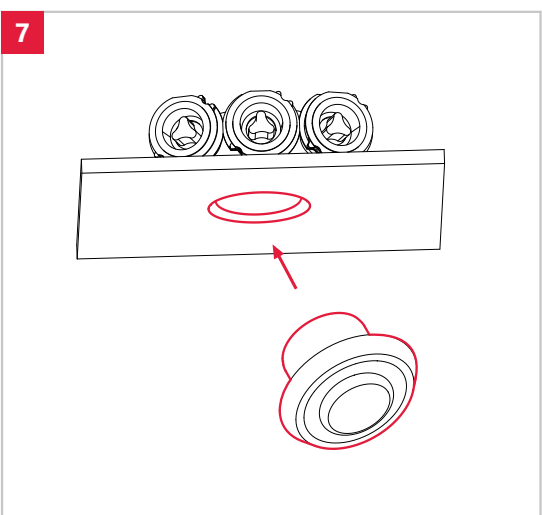
**HEATPEX SP. ZO.O.**

80-044 Gdańsk ul. Trakt św. Wojciecha 29

Tel./Fax: +48 58 3090283

E-mail: support@heatpex.pl